



AQ-MF-1-R

Under Sink Water Filter

Claryum[®] Direct Connect

REPLACEMENT

Owner's Manual

For use with AQ-MF-1

INSTALLATION STEPS

- 1 Turn off COLD water supply under the sink.

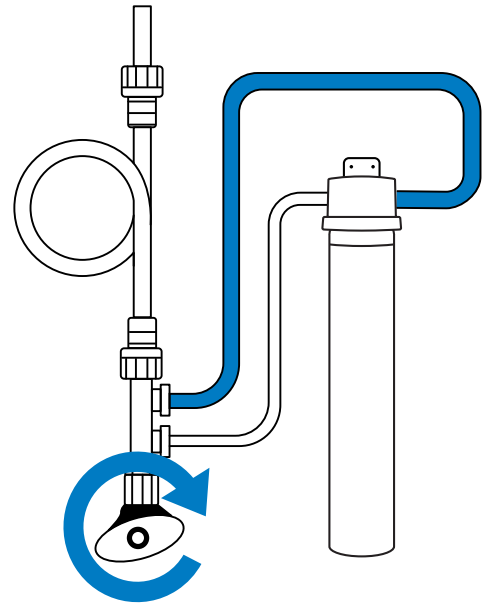

- 2 Remove the old filter from the system head. Rotate the filter to the left until it unlocks, pull down and discard.

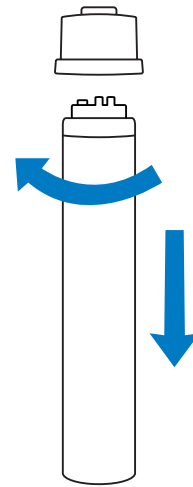

- 3 To attach new filter to the system, align all connection points, push in, and turn filter to the right until it locks.

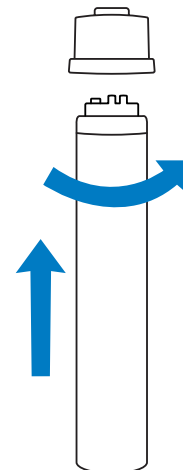

NOTE: Do not use tools to tighten. Hand tighten only.

INSTALLATION STEPS

- 4 Once filter is locked into place, turn on the COLD water supply to pressurize the system. Check for leaks.

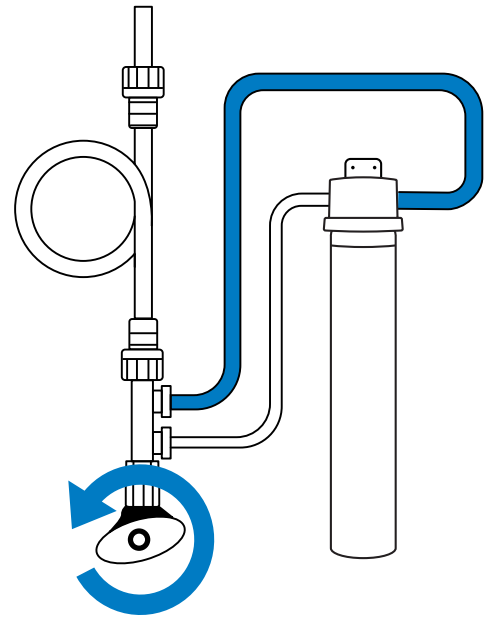

- 5 Turn on kitchen faucet to COLD water and run water through the system at least for at least 15 minutes. Once the system is flushed, turn off kitchen faucet.

NOTE: Do not drink flushed water.

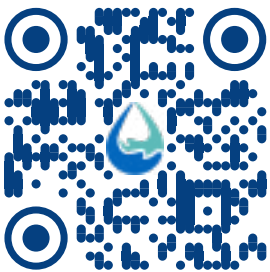

Scan to view the
Claryum® Direct Connect
replacement video.



**Protect your investment and save money
with our Water for Life® program.**



**Extended
Warranty**



**Discounted
Replacements**



**Free
Shipping**



**No
Contract**

CONTACT US TO LEARN MORE 866-662-6885

waterforlife@aquasana.com



System certified by IAPMO R&T
against NSF/ANSI Standards 42, 53,
and 401 for the reduction of the
claims specified on the Performance
Data Sheet and at www.IAPMO.org.



For the full list of
contaminants filtered,
scan to view the
Performance Data Sheet
on Aquasana.com.

The recommended replacement frequency for the AO-MF-1-R is every 6 months or every 784 gallons of use. Use only certified, genuine Aquasana replacement filters for continued contaminant removal and system performance.

Do not use with water that is microbiologically unsafe or of unknown quality without adequate disinfection before or after the system.

Aquasana, Inc.
6310 Midway Road
Haltom City, Texas 76117
866.662.6885 USA
877.332.7873 Canada
www.aquasana.com

AQ-MF-1-R_OM_060920